

EMMET COUNTY, IOWA
PERMIT TO CONSTRUCT/WIDEN
 DRIVEWAY FIELD ENTRANCE

Applicant _____ Telephone Number _____

Address _____
 (Street/Post Office Box) (City) (State) (Zip Code)

In accordance with the policy of the Emmet County Board of Supervisors, applications for installation, widening, or moving of driveways and field entrances must be approved by the Engineer's Office. Construction of driveways and field entrances may be by applicant or County forces (at an established schedule of costs). After approval of location, the County reserves the right to schedule construction date.

Please use the following diagram of a typical section to locate the proposed driveway or field entrance and answer the questions listed.

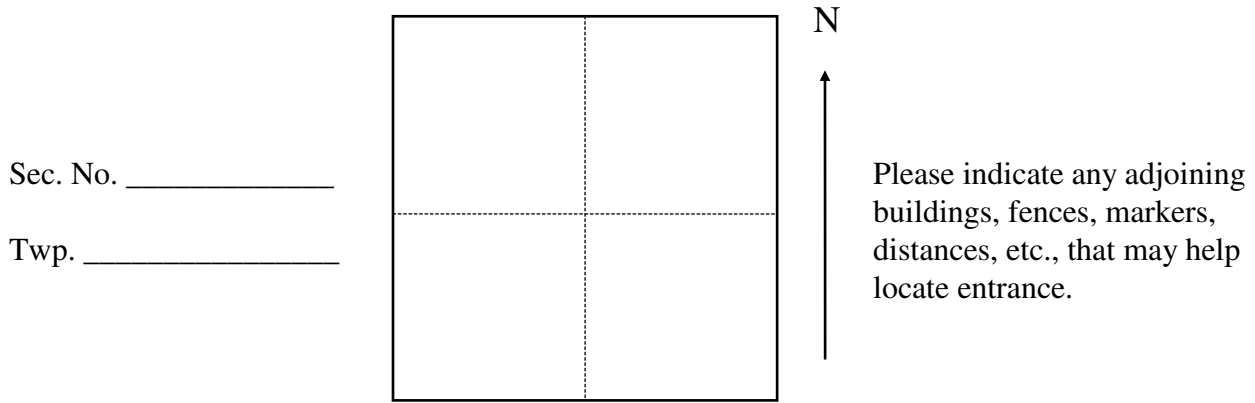

Desired finished width of entrance _____ ft. Existing width (if applicable) _____ ft.

Constructed by _____ Approximate Date _____

Material to be used _____

Is this location on a paved road? _____ Drainage Pipe necessary? _____

Date: _____

Signature of Applicant

----- Office Portion -----

Safety slopes will • will not • be required.

Reviewed by _____ Date _____

Approved by _____ Date _____

R E S O L U T I O N

95-4

DRIVEWAYS AND FIELD ENTRANCES

In accordance with the Policy and Regulations of the Emmet County Board of Supervisors, the following schedule of costs will apply for the installation, widening, moving of driveways and field entrances. Emmet County reserves the right to schedule actual construction.

SCHEDULE OF COSTS

Emmet County will stock the material and furnish the labor and equipment to construct the driveway or field entrance. The person requesting the driveway or field entrance will pay for the material at the following rate:

Dirt - \$22.50 per small truck load (4.5 Cu.Yd./3.4 m³)
\$40.00 per tandem truck load (8 Cu.Yd./6.1 m³)
with a minimum of \$90.00 for driveways not using pipe.

Gravel - All field entrances to be graveled by the County shall be at a cost of \$6.00 per ton, delivered. House drives will be graveled at no charge.

Where pipe is required, the owner shall pay for the actual cost of the pipe in addition to the dirt.

Widening Entrances - It will be the actual cost of the pipe, if needed, and \$22.50 per small truck load of dirt or \$40.00 per tandem truck load of dirt.

Moving of field entrances and driveways will be done at negotiated cost.

Drives shall not be placed by the landowner or tenant on any road without the consent of the Engineer, even though the owner or tenant does the work. Driveways requiring pipe shall have the minimum diameter of 15" (375-390 mm) and shall be 16 gauge corrugated metal or tongue and groove reinforced concrete pipe per current Standard Road Plan RF-1. Driveways placed without such consent shall be subject to removal at owner's expense.

Amended Date: 11/28/06

Chairman
Emmet County Board of Supervisors